

ALDRIDGE

TRAFFIC  
TECHNOLOGIES

Moving Traffic Safer,  
Smarter and Greener

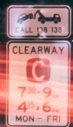



## TTL Group of Companies

### Traffic Technologies Ltd

Head Office

31 Brisbane Street  
Eltham Victoria 3095  
Australia

T: + 61 3 9430 0222

Offices in:

- Northern Territory
- Tasmania
- Queensland
- Western Australia
- Victoria
- New South Wales

[www.trafficltd.com.au](http://www.trafficltd.com.au)



ASSOCIATE MEMBER



Associate Member

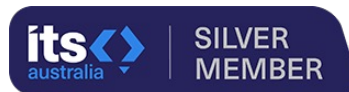

INSTITUTE OF PUBLIC WORKS  
ENGINEERING AUSTRALASIA



Accreditation N<sup>o</sup>.  
10378

### DeNeeffe Signs

Head Office

25 Brisbane Street  
Eltham Victoria 3095  
Australia

T: + 61 3 9430 0266

### Aldridge Traffic Systems

12-14 Leeds Street,  
Rhodes  
NSW 2138  
Australia

T: + 61 2 9701 9900

### QTC Traffic Solutions

12-14 Leeds Street  
Rhodes  
NSW 2138  
Australia

T: + 61 2 9701 9900

### Aldridge Traffic Systems UK

Units D3+D5  
Cowlairs  
Southglade  
Business Park  
off Rigley Drive  
Top Valley  
Nottingham  
NG5 9RA  
UK

T: + 44 7400 189720

### i:TS Intelligent Traffic Systems

84 Bluestone Circuit,  
Seventeen Mile Rocks  
QLD 4074  
Australia

T: 1300 769 852  
info@itsau.com.au



# TfNSW Type Approved



Intelligent Transport Systems

# Type Approval

Certificate No: ITS-TAN000134

Issued to:

Aldridge Traffic Systems (ATS)

For:

Device Type	Traffic lanterns – HPSM (CLS)		
TfNSW Specification:	TSI-SP-045	Version:	2.0

Summary Scope:

Sizes: 200mm and 300mm.

Variants: Roundels and Symbolics, both sizes. Red, Yellow, and Green.  
Available lantern body types are Aluminium, Enviro-Recycle and Polycarbonate.

Models: RAXXX-CLS, RAXXX-CLS-G and RAXXX-CLS-PLA series of lantern aspect and body type configurations.

Evaluation Reference:	ITS-EV0292	Approver	Snr Manager Specifications and Evaluations
Approver Signature:	<i>Raj J. Roychoudhry</i>	Date	31 <sup>st</sup> July 2023



With a focus on Energy Saving, Recycling and Cost Efficiency for councils and customers, Aldridge Traffic Systems is at the forefront of Australia's manufacturing of Traffic Signals and Hardware, Road Lighting, Signage and Smart City Software Solutions.

We are delighted to introduce our latest product, **GO GREEN** Enviro Lantern Housing. The first recyclable housing 100% manufactured by Aldridge in Australia.

With relentless research and development, Aldridge has continued stay ahead of the latest developments and technologies, specialising in all aspects of road safety hardware and smart technology. Our team of skilled designers and expert engineers have an exceptional knowledge of the traffic industry collated over numerous years.

### TST Smart City Solutions

TST offers smart functionality, with expert guidance and smart solutions that solve and guide informed decisions through smart monitoring tools and software, that manage safety for all road users, boost energy efficiency, and reduce environmental impact.



**ALDRIDGE**

# Go Green – Australia's first recycled onshore-manufactured Enviro Lantern Housing

Aldridge Traffic Systems has developed the **GO GREEN Enviro Lantern Housing** incorporating eco-design principles and considering stringent traffic signalling requirements. This eco-friendly housing not only meets the necessary Australian Standards (AS-NZS-5377 and AS-2144) but contributes towards global sustainability by reducing CO2 emissions from product manufacture and energy reduction.







ALDRIDGE

# Managing Road Safety





- Manufactured by Aldridge in Australia.
- LED 200mm & 300mm lanterns.
- 1,2,3,4 aspect.
- Available in 12VDC, 24VDC, 42V, 110V, 230V.
- AS 2144.
- Aluminium, Polycarbonate and Recyclable Go Green Enviro Housing Available.
- High luminous output.
- Long-term reliability.
- No veiling reflection.



LED Vehicle Lanterns 200mm & 300mm

## CLS Central Light Source

- HPSM (high pressure surface mount) LED.
- Available in:
  - 230V AC (LV)
  - 42V AC (ELV) Dim by Wire.
- Sizes 200mm & 300mm.
- 1,2,3,4 Aspect.
- AS 2144.
- Aluminium, Polycarbonate and Recyclable Go Green Enviro Housing Available.



Accreditation No.  
10378

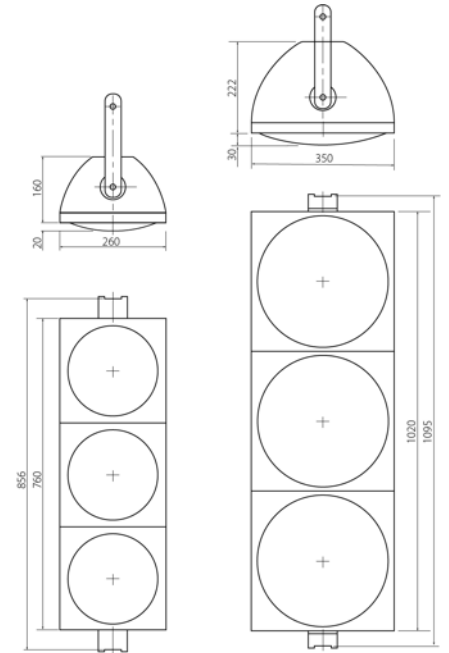

## CLS Vehicle Lanterns 200mm & 300mm



## CLS Symbolic Lanterns

- Available in:
  - 230V AC (LV)
  - 42V AC (ELV) Dim by Wire.
- Sizes 200mm & 300mm.
- AS 2144.
- Aluminium, Polycarbonate and Recyclable Go Green Enviro Housing Available.



CLS Symbolic Lanterns 200mm & 300mm

## LED Symbolic Lanterns

- Sizes 200mm.
- AS 2144.
- IP35 or IP65 Protection.
- Aluminium, Polycarbonate and Recyclable Go Green Enviro Housing Available.







- LED Retrofit Optics, including door and assembly flying leads.
- LED Available in 12VDC, 24VDC, 42V, 110V, 230V.
- CLS Retrofit Optics, including door and assembly flying leads.
- CLS Available in:
  - 230V AC (LV)
  - 42V AC (ELV) Dim by Wire.
- AS 2144.
- High luminous output.
- Full range of optics available.
- Long-term reliability.
- Easy to install.
- Energy saving benefits.

LED & CLS Retrofit Optics 200mm & 300mm

## Dual Voltage

As 42V AC is rated ELV, traffic operators and on-site installers avoid the risk of electrical contact. As most of the intersections operate on 240V AC Aldridge has developed a 240/42V AC Dual Voltage LED traffic lantern to make the transition progressive.



## 240/42V Dual Voltage LED Lantern



**ALDRIDGE**

## LED 12V & 24V

Aldridge LED signal lanterns can operate directly from 24V DC supply or direct from a 12V DC supply. Both versions are designed with smooth, uniform light distribution with IP65 rated protection against moisture and dust, which make them ideal for use in mining applications.



**24V DC & 12V DC LED Lantern**



An aerial photograph of a busy pedestrian crossing. A group of diverse people, including children, adults, and a person with a stroller, are walking across the crosswalk. A white car is stopped on the left side of the road, and a dark grey van is also stopped. A motorcycle is also visible on the road. The scene is set on a paved street with clear crosswalk markings. The lighting suggests a bright, sunny day, casting distinct shadows.

ALDRIDGE

# Managing Pedestrian Safety



- Meets all requirements of AS 2144.
- Durable thermoplastic components.
- Exceptional structural strength.
- U.V. stabilised components.
- Adjustable lantern mounting centres.
- Aluminium, Polycarbonate and Recyclable Go Green Enviro Housing Available.
- Suits all weather and operating environments.



## CLS Pedestrian Lanterns 200mm

# ALDRIDGE



- Meets all requirements of AS 2144.
- High luminous output.
- Operates in high temperatures.
- Moisture resistant.
- LED's driven at low current in order to avoid premature ageing.
- Compatible with existing traffic controllers.
- Long-term reliability and operational life.
- Low output degradation.
- Low sun-phantom intensity.
- No veiling reflection.
- Can operate with solar power.
- Durable thermoplastic components.
- Exceptional structural strength.

## LED Pedestrian lanterns 200mm





- Utilising the latest in LED technology for low power, high brightness, and long operational life.
- Built-in intelligence to detect the pedestrian clearance period.
- Designed to operate with RTA Equipment Specification No. TSC/4 for Pedestrian Traffic Signals.
- No additional programming or configuration required.
- Australian designed and Manufactured.
- Available with IP65 Signal Lanterns Housings.
- U.V. stabilised components.
- Fits standard 200mm Traffic Signal Lantern Housings.
- Simple installation for new or existing traffic signals.



200mm



300mm

## Pedestrian Countdown Displays



A nighttime city street scene with light trails from traffic and illuminated skyscrapers. In the foreground, a traffic light shows a green arrow pointing right. A red rectangular box is in the top right corner.

**QTC**



# VC6 Controller





## VC6 TRAFFIC CONTROLLER\*

Command Module fully compatible with latest TRAFF versions and amendment to TSC/4.  
The new Command Module CM3248-VC6 from QTC is designed to run the latest RMS Traff VC6 software and supports 32 signal groups, 48 loops inputs plus 8 pedestrian push button inputs plus additional SPIP and SPOP 24/24 and latest VC6 Traff version for the latest SCATS 6.9.4.

**\*Certification Pending**



# VC6 Traffic Controller – SCATS V. 6.9.4



ALDRIDGE



Keeping the vulnerable safe with the Aldridge iTouch

- Manufactured by Aldridge in Australia.
- Provides both tactile and audio indication facilities.
- Emits a continuous audio signal to aid push-button assembly location and identification.
- Distinct audio and tactile signal for positive walk (cross) indication.
- Reliable proven audio and tactile transducer.
- Sensitive ambient noise monitoring.
- Factory adjustable zero set, change tone, tactile, walk tone and don't walk tone levels.



## Audio Tactile Pedestrian Detector





- iTouch can be retrofitted to existing Push Button Units.
- Provides both tactile and audio indication facilities.
- iTouch Proximity Sensor activates within (3cm - 12cm) range.
- Emits a continuous audio signal to aid push-button assembly location and identification.
- Distinct audio and tactile signal for positive walk (cross) indication.
- Audible signal level controls, automatically adjust for ambient noise.
- Solid state circuitry, proven transducer ensures ultimate safety and reliability.
- iTouch with Call Record available.
- New - iTouch V2, 24V Microwave – available.

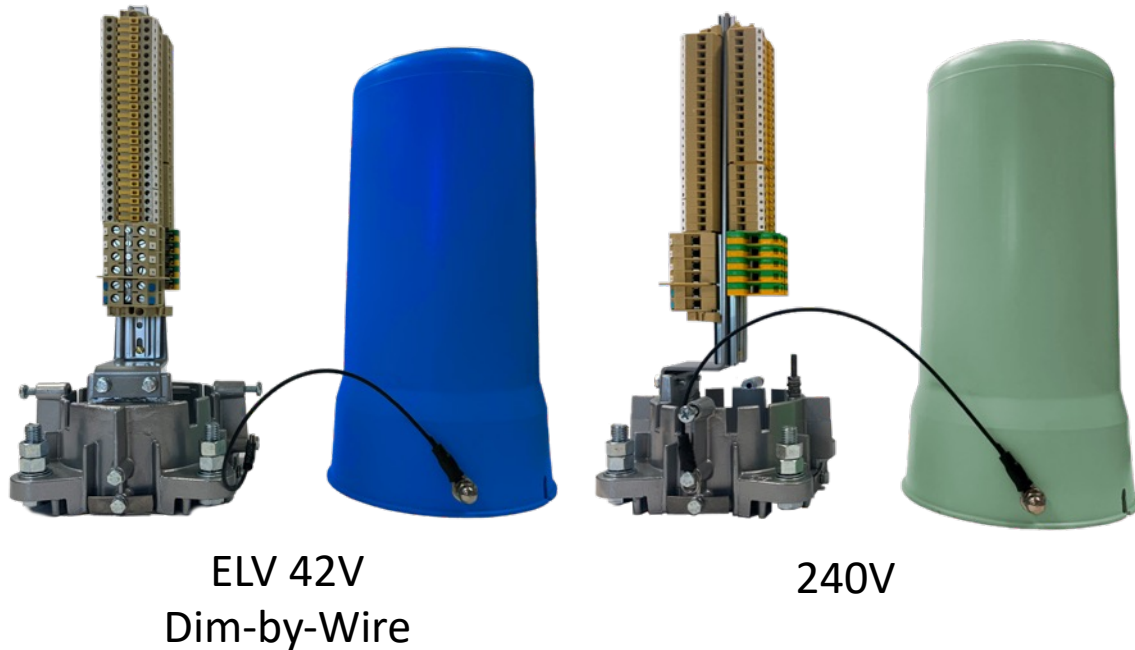

Designed to mount on standard 100mm posts the ATS upper mounting bracket, terminal assembly and finial cap combine to form the upper mounting post top assembly. A selection of terminal assembly requirements to meet individual needs and international wiring regulations are available. The upper mounting bracket provides for 4 lantern mounting points and up to 8 cable entry points. ELV (DBW) offers extra low voltage, without compromising on performance.

- Target Boards all Configurations.
- Arrow Symbols.
- Post Top Mounting Assemblies.
- Closed Type Visors.
- Cutaway Visors.
- Pole Mounting Brackets.
- Vertical & Horizontal Louvres.

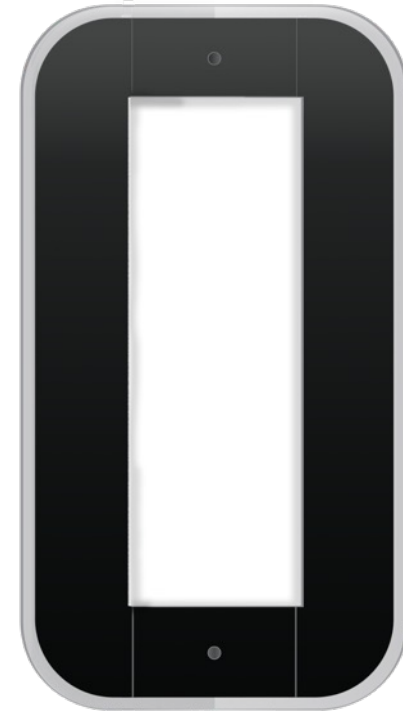
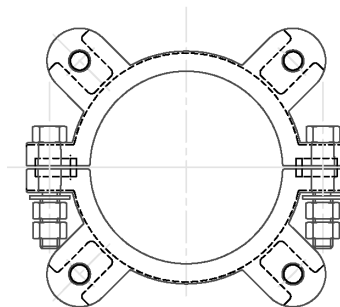



ALDRIDGE

# Smart Lighting





ALDRIDGE

# Smart City Ready - Road, Street, Tunnel & Decorative Lighting



- P LED Lighting
- V LED Lighting
- Decorative Lighting
- Solar Lighting
- Flood Lighting
- Stadium Lighting
- Bollard Lighting
- Tunnel Lighting



## Smart Lighting Solutions





# Smart-City Capabilities

**ALDRIDGE**

# TST Smart City Sensor Technology



23  
Countries

128  
Cities

+31,000  
Intersections

+600,000  
Devices

+25,000,000  
Data Points





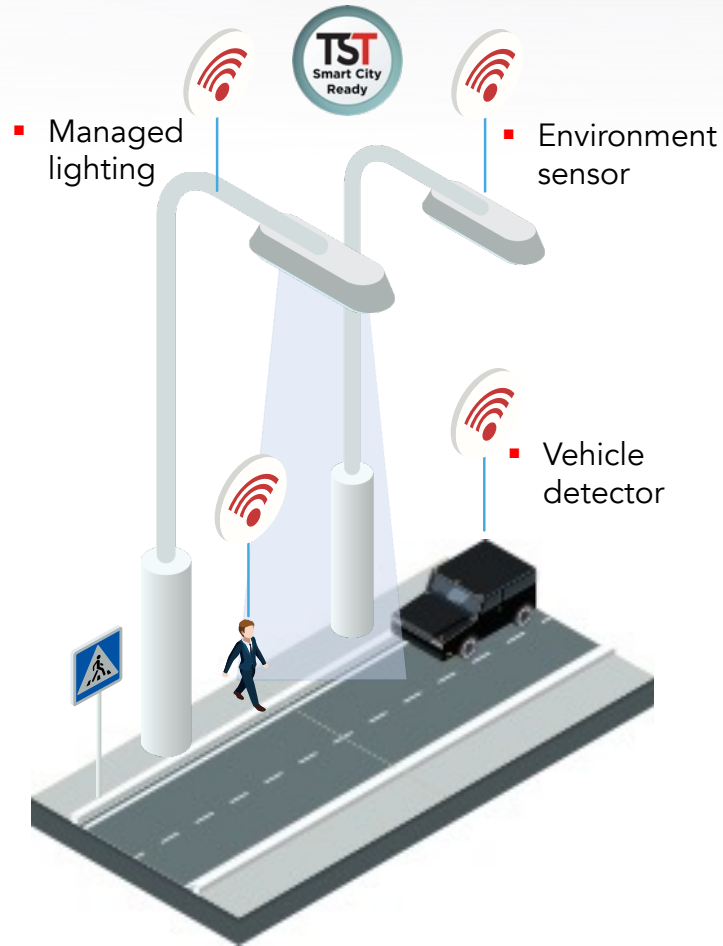

Enhanced services  
 data stored in cloud



- Managed service
- Data analysis
- Asset control
- Asset maintenance
- Data driving asset renewals

Lighting – outcome-driven operation  
 importance of analytics

- Ability to Understand Trends.
- Maintenance aimed at Operation, not Compliance.
- Getting to What's Important.
- Instant Visualisation.
- Efficient Deployment of Resources.
- Shapes Future Deployments.

Hardware, software and sensors



ALDRIDGE

## Notable Clients



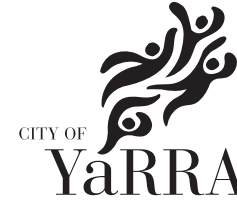

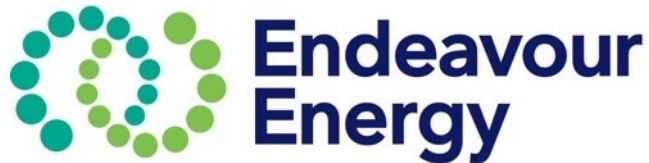



# TTL Group of Companies

**Traffic Technologies Ltd**  
Technologies Ltd

Head Office  
  
31 Brisbane Street  
Eltham Victoria 3095  
Australia  
  
T: + 61 3 9430 0222

- Offices in:
- Northern Territory
  - Tasmania
  - Queensland
  - Western Australia
  - Victoria
  - New South Wales

[www.trafficltd.com.au](http://www.trafficltd.com.au)



Accreditation N<sup>o</sup>.  
10378



**DeNeeffe Signs**  
DeNeeffe Signs

Head Office  
  
25 Brisbane Street  
Eltham Victoria 3095  
Australia  
  
T: + 61 3 9430 0266

**Aldridge Traffic Systems**  
Systems

12-14 Leeds Street,  
Rhodes  
NSW 2138  
Australia  
  
T: + 61 2 9701 9900

**QTC Traffic Solutions**  
Solutions

12-14 Leeds Street  
Rhodes  
NSW 2138  
Australia  
  
T: + 61 2 9701 9900

**Aldridge Traffic Systems UK**  
Systems UK

Units D3+D5  
Cowlairs  
Southglade  
Business Park  
off Rigley Drive  
Top Valley  
Nottingham  
NG5 9RA  
UK  
  
T: + 44 7400 189720

**i:TS Intelligent Traffic Systems**  
Traffic Systems

84 Bluestone Circuit,  
Seventeen Mile Rocks  
QLD 4074  
Australia  
  
T: 1300 769 852  
info@itsau.com.au